

edge banders, sizing edge banders

# olimpic k 360

compact automatic edge bander



# olimpic k 360

compact automatic **edge bander**

**Versatility and high machining quality** with the SCM olimpik K 360, the machine with the aim to be the new reference point in the market for **entry level edge banders and complete with a rounding unit.**

**Compact and easy-to-use** due to its advanced technological solutions designed to ensure optimal panel finishing. It is simply the perfect edge bander for companies who require continuous and high quality edge banding of panels even though they may be different from one to another.



OLIMPIC		K 360
Panel thickness	mm	8 - 50 (60)
Edge thickness	mm	0,4 - 3 (6)
Feed speed	m/min	11
Compressed air	bar	6



- cutting
- edge banding**
- boring-routing
- calibrating-sanding
- assembling

# olimpic k 360

technological advantages



## END CUTTING UNIT: CUT AND "RADIUS" IN A SINGLE OPERATION

Automatic and error free cutting of thick edges due to the particular system with two blades that allows the straight cutting of solid wood edges and the chamfering of the thin edges.



## ROUNDING UNIT: EDGE ANGLES FINISHING ON STRAIGHT AND SHAPED PANELS

Rounding of front and rear edge angle on straight, chamfered and post-formed panels. The operation is automatically carried out by the unit and grants an optimal finishing, without necessity of further machining.



## TOUCH 7 CONTROL: JUST A "TOUCH" TO USE THE MACHINE

Error free machining with the touch-screen display with its customised graphics that allows an intuitive and easy selection of the main machine functions.



# olimpic k 360

controls and **operating** units

## ORION ONE PLUS: SIMPLE AND INTUITIVE MACHINE USE

The control with its buttons and customised graphics and 4" display allows an easy and **error-free machining**.



## AAR ANTI-ADHESIVE UNIT

The highest level of panel cleaning by utilising spray guns that prevent any sticking of excess glue on the upper and lower panel surfaces (opt.).

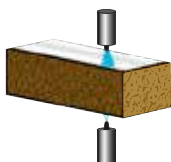

## RT-VI PRE-MILLING UNIT: A PERFECT EDGE JOINT LINE

A perfect surface for the gluing of the edge by utilising large diameter diamond tools (100 mm) and 2 motors with opposite rotation.

- pre-milling up to 3 mm thickness
- adjustment of the tool cutting position

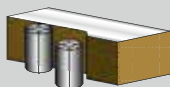

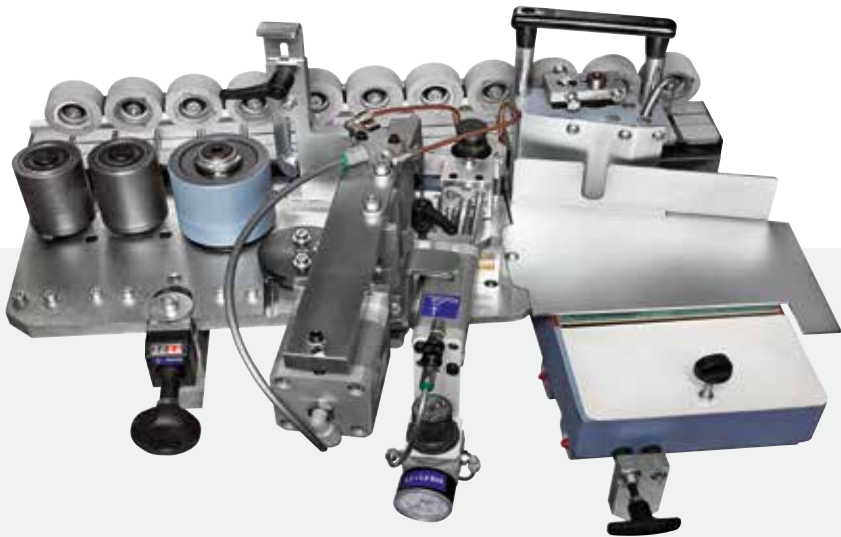

**VC-VM GLUING UNIT:  
PERFECT EDGE APPLICATION**

Optimal edge gluing is guaranteed by a particular glue spreading roller providing a **uniform and optimised glue application** on all types of material.  
- Rapid glue pot substitution and double thermoregulation system for the use of 2 types of glue (option)

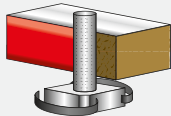

**KIT FOR MACHINING OF  
EDGES IN STRIPS**

Automatic loading of edges in strips (opt.).

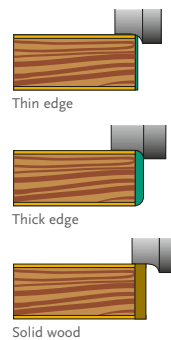

**R-K TRIMMING UNIT:  
3 DIFFERENT MACHINING**

**Rapid machining changeover** between thin, thick and solid wood edges due to the 3 working positions and the "Combi" tool supplied as a standard feature.

- automatic positioning of the unit for 3 different machining (option)

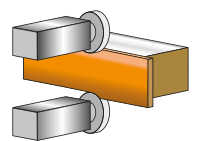

**K-2 END CUTTING UNIT:  
ALWAYS GIVES THE BEST CUTTING QUALITY**

The best finishing quality in every edge banding operation using motors sliding on prismatic guideways without mechanical play.

- "radius", chamfered and straight cut of the edge (opt.).



# olimpic k 360

operating groups

## ROUND | ROUNDING UNIT EDGE ANGLES FINISHING ON STRAIGHT AND SHAPED PANELS

Rounding of front and rear edge angle on straight, chamfered and post-formed panels. The operation is automatically carried out by the unit and grants an optimal finishing, without necessity of further machining.

- automatic positioning of the unit for 2 different machining (opt.)

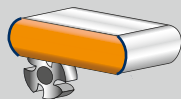

## RAS-V EDGE SCRAPING UNIT: FOR A PERFECT RADIUS OF PVC/ABS EDGES

High finishing quality of the plastic edges, thanks to the complete elimination of the marks left from the tools during trimming operations.

- Extraction hood complete with a suitable container and filter for long chips

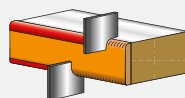

## NESTING COPYING DEVICES

The best panel finishing with **holes for hinges** on the upper side due to the copying devices with 3 rotating contact points (optional device for trimming unit and edge scraping unit) (option).







**RC-V GLUE SCRAPING GROUP:  
A PERFECT EDGE JOINT LINE**  
It eliminates any excess glue on the panel/edge joint.  
It allows the **removal of any excessive plastic edges**  
(0,1 mm for edges up to 1 mm) (opt.).

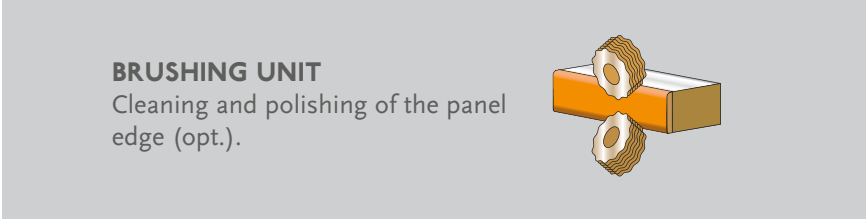

**BRUSHING UNIT**  
Cleaning and polishing of the panel  
edge (opt.).



**PANELS FEED TRACK**  
Better **holding and movement linearity** of the  
panel due to the large dimensioned industrial  
chain (1-1/4”).



**LOWER CONSUMPTION =  
LOWER COSTS**  
Sav€nergy allows the use of **power only  
when it is required**, making things operate  
only when they are really necessary. It  
means the machine automatically enters  
“stand-by” mode when there are no  
panels to be machined at any particular  
time . Year saving up to 10% (opt.).

# olimpic k 360

technical data and configurations

## OLIMPIC K 360

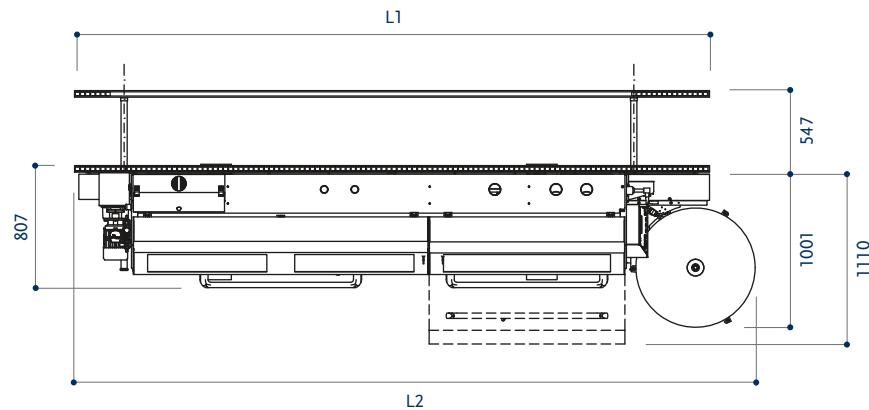

Compositions	E	T-E	ER1	T-ER1
Length-L1 (mm)	2550	3116	4152	4152
Length-L2 (mm)	2829	3395	4431	4431

## OLIMPIC K 360

available solutions

<b>E</b>	1S	1/2								
<b>T-E</b>	1S	1/2								
<b>ER1</b>	1S	1/2								
<b>T-ER1</b>	1S	1/2								
<b>I GRUPPI OPZIONALI</b>	1S	→		1/2	→					

NOISE LEVEL ACCORDING TO THE REFERENCE STANDARD EN 1218-4:2004\*A2:2009

# THE STRONGEST WOOD TECHNOLOGIES ARE IN OUR DNA

## SCM. A HERITAGE OF SKILLS IN A UNIQUE BRAND

Over 65 years of success gives SCM the centre stage in woodworking technology. This heritage results from bringing together the best know-how in machining and systems for wood-based manufacturing. SCM is present all over the world, brought to you by the widest distribution network in the industry.

65 years history

3 main production sites in Italy

300.000 square metres of production space

17.000 machines manufactured per year

90% export

20 foreign branches

350 agents and dealers

500 support technicians

500 registered patents

In SCM's DNA also strength and solidity of a great Group. The SCM Group is a world leader, manufacturing industrial equipment and components for machining the widest range of materials.

## SCM GROUP, A HIGHLY SKILLED TEAM EXPERT IN INDUSTRIAL MACHINES AND COMPONENTS

### INDUSTRIAL MACHINERY

Stand-alone machines, integrated systems and services dedicated to processing a wide range of materials.



WOODWORKING TECHNOLOGIES



TECHNOLOGIES FOR PROCESSING COMPOSITE MATERIALS, ALUMINIUM, PLASTIC, GLASS, STONE, METAL

### INDUSTRIAL COMPONENTS

Technological components for the Group's machines and systems, for those of third-parties and the machinery industry.



SPINDLES AND TECHNOLOGICAL COMPONENTS



ELECTRIC PANELS



METALWORK



CAST IRON



The technical data can vary according to the requested machine composition. In this catalogue, machines are shown with options. The company reserves the right to modify technical specifications without prior notice; the modifications do not influence the safety foreseen by the CE Norms.



is more



**SCM GROUP SPA**

via Casale 450 - 47826 Villa Verucchio, Rimini - Italy  
tel. +39 0541 674111 - fax +39 0541 674274  
scm@scmgroup.com  
www.scmwood.com



00L0365470H