

DOUCET

EDGE GLUING AND LAMINATION

RT100
ROBOTIC OPERATOR

THE "ALTERNATIVE
LABOR FORCE"
FOR CLAMP CARRIERS

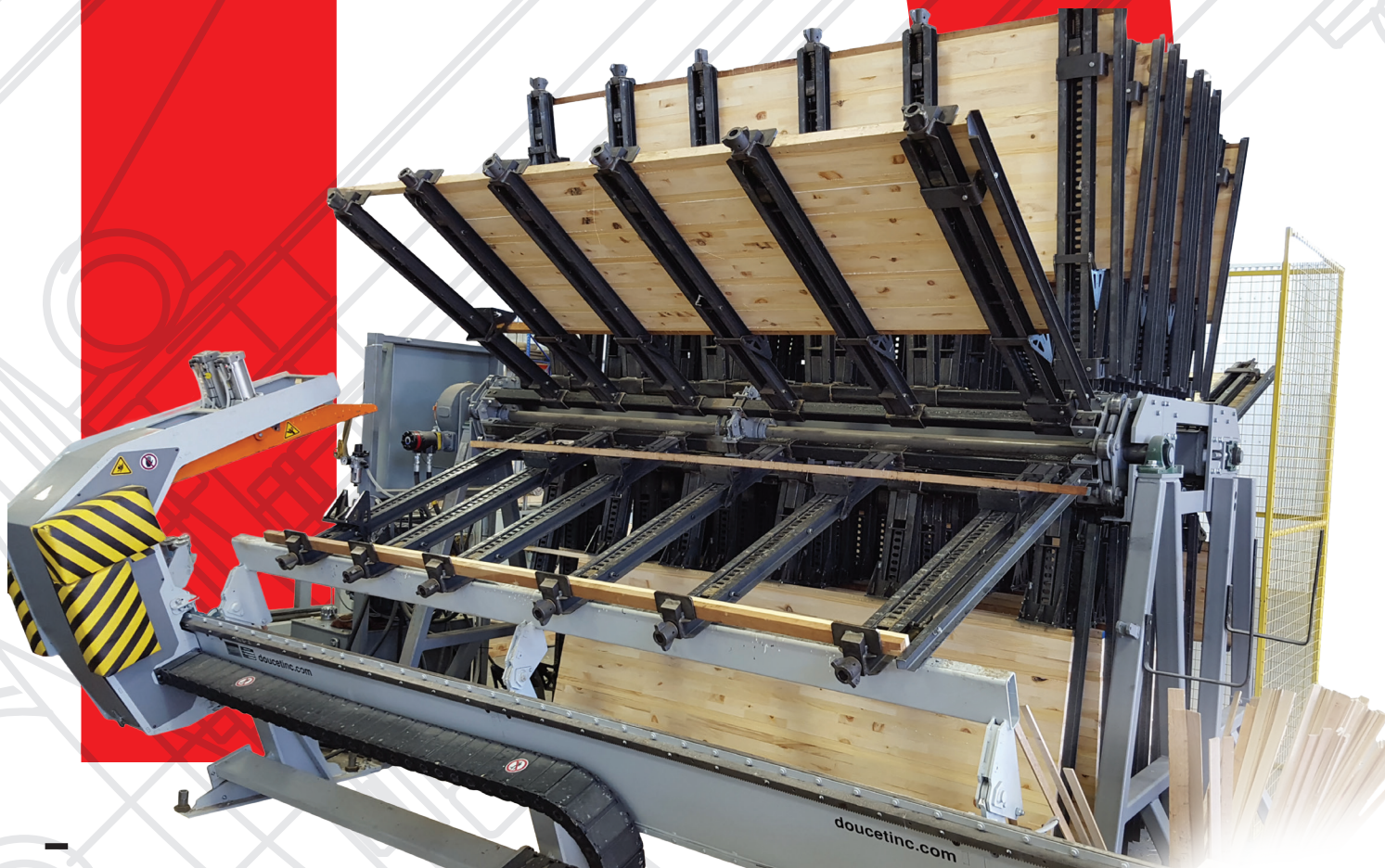

CUTTING EDGE
SOLUTIONS FOR THE
WOODWORKING INDUSTRY

RT100

THE ROBOTIC OPERATOR - MODEL RT100 ALLOWS YOU TO BOOST THE PRODUCTIVITY OF YOUR PANEL ASSEMBLY OPERATION WHILE KEEPING YOUR LABOR COST UNDER CONTROL AND AN OPTIMIZED CYCLE TIME.

RT100 has the fastest and accurate movement of the carriage by a powered rack and pinion linear rail. It is available as a modular upgrade of existing Clamp Carriers or as part for a new one.



STANDARD FEATURES

- ▶ The fastest robotic operator on the market: tightens 6 clamps along a 8 foot raceway, rotates the next section and loosens the 6 clamps on the next section in less than 35 seconds
- ▶ The RT100 features a moving carriage with double pneumatic cylinder panel flatteners with sensor for detecting short wood
- ▶ Quick and accurate movement of the carriage is made possible by a powered rack and pinion linear rail
- ▶ With employee safety at the heart of our concerns, the RT100 is equipped with two safety cushions with an emergency device that stops in case of contact with the employee

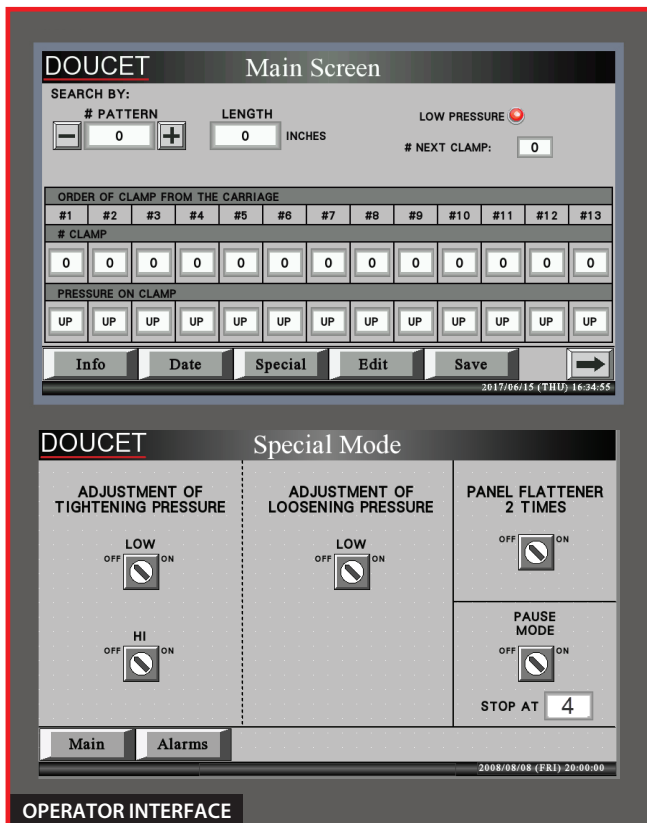

OPTIONS

- ▶ Additional features on RTS & RTSP package including:
 - Create special clamping sequences with saving capabilities
 - Pause cycle for panel inspection before rotating
 - Double Kick of the panel flattener before tightening
 - Setup mode to adjust pressure levels for tightening sequence
 - Setup mode to adjust lower pressure levels for pre-tightening sequence (RTSP only)
- ▶ Laser sensor to preset the opening of the clamp for the next load